

FEATURES

- Stainless steel IP67 dual shear beam load cell
- High accuracy
- Suitable for truck scales and other heavy weighing devices
- Sealed construction



AVAILABLE MODELS

xxklb	A5M/B10M	B9C-xx-xxK-9B
NTEP A5S/B10M Certificate (Klb-250Klb)		
xxklb	C3/C4/A5M/B10M	H9C-xx-xxK-9B
5klb-250klb approved by PTB C3.		
5klb-20klb approved by PTB C4.		
5klb-250klb approved by NTEP A5M/B10M.		



SPECIFICATION

Maximum capacity (E _{max})	klb	5/10/15/20/30/40/50/60/75/90/100/150/200/250			
Accuracy class		C3	C4	A5M	B10M
Maximum number of load cell intervals (nLC)		3000	4000	III5000 Multiple	IIIL10000 Multiple
Ratio of minimum LC verification interval Y=E _{max} / V _{min}		10000	14000	15000	10000
Combined error	%FS	±0.020	±0.018	±0.026	±0.050
Creep	%FS/30min	±0.016	±0.012	±0.017	±0.040
Temperature effect on sensitivity	%FS/10°C	±0.011	±0.009	±0.013	±0.040
Temperature effect on zero	%FS/10°C	±0.015	±0.010	±0.014	±0.020
Output sensitivity (=FS)	mV/V	3.0±0.008			
Input resistance	Ω	700±7			
Output resistance	Ω	703±4			
Insulation resistance	MΩ	≥ 5000 (50VDC)			
Zero balance	%FS	±1.0			
Compensated temperature	°C	-10~+40			
Operating temperature	°C	-35~+70			
Excitation, recommended voltage	V	5~12 (DC)			
Excitation maximum	V	18 (DC)			
Safe overload	%FS	150			
Ultimate overload	%FS	300			
ATEX classification (optional)		II1G Ex ia II1C T4	II1D Ex iaD20 T73°C	II3G Ex nL II C T4	

DIMENSIONS IN MM

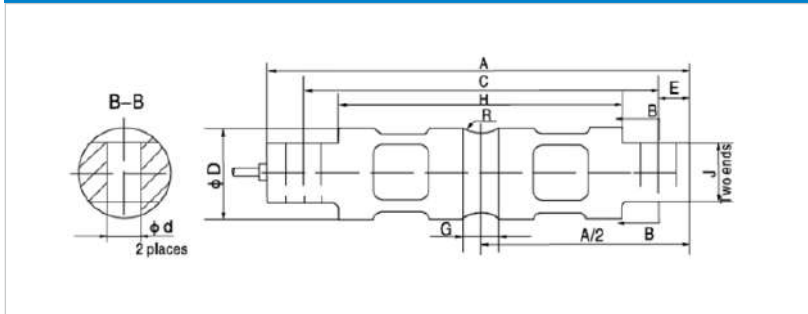

Dimension Capacity	A	C	H	G	ΦD	J	Φd	R	E
5Klb, 10Klb	206.2 (8.12)	174.6 (6.88)	133.1 (5.24)	15.7 (0.62)	43.2 (1.7)	28.4 (1.12)	16.7 (0.66)	R12.7 (0.5)	15.7 (0.62)
15Klb, 20Klb	206.2 (8.12)	174.6 (6.88)	133.1 (5.24)	21.3 (0.84)	49.5 (1.95)	28.4 (1.12)	16.7 (0.66)	R12.7 (0.5)	15.7 (0.62)
30Klb, 75Klb	260.4 (10.25)	215.9 (8.5)	165.1 (6.5)	25.4 (1.0)	76.2 (3.0)	60.2 (2.37)	26.9 (1.06)	R25.4 (1.0)	22.4 (0.88)
90Klb, 100Klb	285.8 (11.25)	241.3 (9.5)	190.2 (7.49)	31.0 (1.22)	88.9 (3.5)	63.5 (2.5)	26.9 (1.06)	R38.1 (1.5)	22.4 (0.88)
150Klb	285.8 (11.25)	241.3 (9.5)	190.2 (7.49)	31.0 (1.22)	99.1 (3.9)	71.1 (2.80)	26.9 (1.06)	R38.1 (1.5)	22.4 (0.88)
200Klb,250Klb	408.9 (16.1)	330.2 (13.0)	254.0 (10.0)	31.7 (1.25)	136.6 (5.38)	116.8 (4.6)	39.6 (1.56)	R50.8 (2.0)	39.4 (1.55)

WIRING

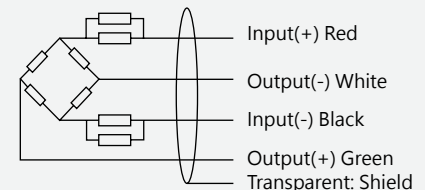

- Shielded, 4 conductor cable.
- Cable diameter for 5k - 20k: Φ5mm and for 30k - 250k: Φ8mm.
- Standard cable length: 9m.
- Shield is not connected to element.