

BM8G

FEATURES

- Stainless steel IP68 shear beam load cell
- Hermetically sealed
- Robust and wide mounting surface
- Suitable for harsh environment
- Current calibrated (sc-option)



AVAILABLE MODELS

xxkg	C3/C4	BM8G-xx-xxkg-5B
xxt	C3/C4	BM8G-xx-xtt-5B
xxklb	C3	BM8G-C3-xxK-5B

500kg-10t approved by OIML C3; 500kg-2t approved by OIML C4.



SPECIFICATION

		OIML R60 C3	OIML R60 C4
Accuracy class			
Output sensitivity (=FS)	mV/V	2.0 ± 0.002	
Maximum capacity (E _{max})	t	0.5/1/2/5/7.5/10	
	lb	1K/2K/5K/10K/15K	
Maximum number of load cell intervals (nLC)		3000	4000
Ratio of minimum LC verification interval Y=E _{max} / V _{min}		10000	15000
Combined error	%FS	± 0.0230	± 0.0175
Minimum dead load	%FS	0	
Safe overload	%FS	150	
Ultimate overload	%FS	300	
Zero balance	%FS	± 1.0	
Excitation, recommended voltage	V	5 ~ 15 (DC)	
Excitation maximum	V	18 (DC)	
Input resistance	Ω	350 ± 3.5	
Output resistance	Ω	350 ± 3.5	
Insulation resistance	MΩ	≥ 5000 (50VDC)	
Compensated temperature	°C	-10 ~ +40	
Operating temperature	°C	-35 ~ +65	
Storage temperature	°C	-40 ~ +70	
Element material		Stainless steel	
Recommended torque on fixation	N.m	M12: 100	M20:450 M24:750
Ingress protection (according to EN 60529)		IP68	

OUTLINE DIMENSION MM(INCH)

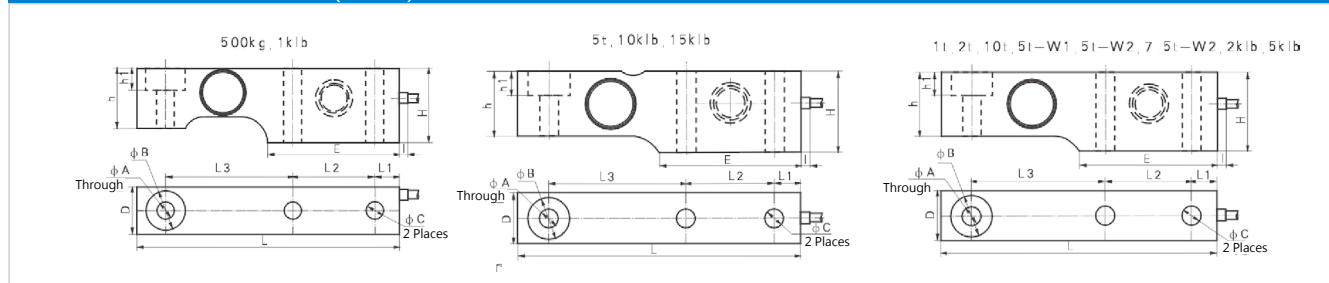

Capacity	Dimension (mm)	A	B	C	D	E	L	L1	L2	L3	H	h	h1	l
0.5t-2t (1klb-5klb)		17.48(0.69)	30.3(1.19)	13.9(0.55)	36.5(1.44)	101.6(4.00)	203.2(8.00)	19.05(0.75)	63.5(2.50)	98.43(3.88)	47.63(1.88)	36.5(1.44)	11.8(0.46)	17(0.67)
1t, 2t, 2klb, 5klb		/	/	/	/	/	/	/	/	/	/	/	11.9(0.47)	/
5t, 7.5t-W2 (10klb-15klb)		25.5(1.00)	41.4(1.63)	22.23(0.88)	47.36(1.86)	117.5(4.63)	234.95(9.25)	20.62(0.81)	66.7(2.63)	123.8(4.87)	69.85(2.75)	47.64(1.88)	15.75(0.62)	17(0.67)
5t-W1		25.5(1.00)	41.3(1.63)	22(0.87)	47.5(1.87)	111(4.37)	234.95(9.25)	20.62(0.81)	66.7(2.63)	123.8(4.87)	50(1.97)	47.6(1.87)	15.8(0.62)	17(0.67)
5t-W2		25.5(1.00)	41.4(1.63)	22.23(0.88)	47.37(1.86)	117.5(4.63)	234.95(9.25)	20.62(0.81)	66.7(2.63)	123.8(4.87)	69.85(2.75)	47.6(1.87)	15.75(0.62)	17(0.67)
10t		25.5(1.00)	41.4(1.63)	25(0.98)	55(2.17)	111(4.37)	234.95(9.25)	20.62(0.81)	66.7(2.63)	123.8(4.87)	69.85(2.75)	58.6(2.31)	15.75(0.62)	17(0.67)

WIRING

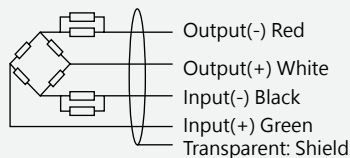

- Adopt shielded, 4 conductor cable: Φ5mm
- Standard cable length: 5m